



REGIONAL INDUSTRIAL DEVELOPMENT CORPORATION

380 LOCUST ST. MCKEESPORT, PA 15132

MANOR II



INDUSTRIAL CENTER OF MCKEESPORT

23,958 RSF INDUSTRIAL SPACE AVAILABLE

THE BUILDING AT A GLANCE

.....

RECENTLY RENOVATED, MANOR II OFFERS APPROX. 85,000 SQ FT OF FLEX, OFFICE AND WAREHOUSE SPACE. THE BUILDING IS LOCATED IN THE INDUSTRIAL CENTER OF MCKEESPORT, WHICH HAS CONVENIENT LINKAGE TO ROUTE 30 AND I-376 W.

- 23,958 SQUARE FEET AVAILABLE (APPROX.)
- HISTORIC FLEX BUILDING
- 33' MAX CLEAR HEIGHT
- 1 DRIVE-IN DOOR
- ON-SITE PARKING
- 20X24 COLUMN SPACING
- SIGNAGE OPPORTUNITY
- ABUNDANCE OF NATURAL LIGHT

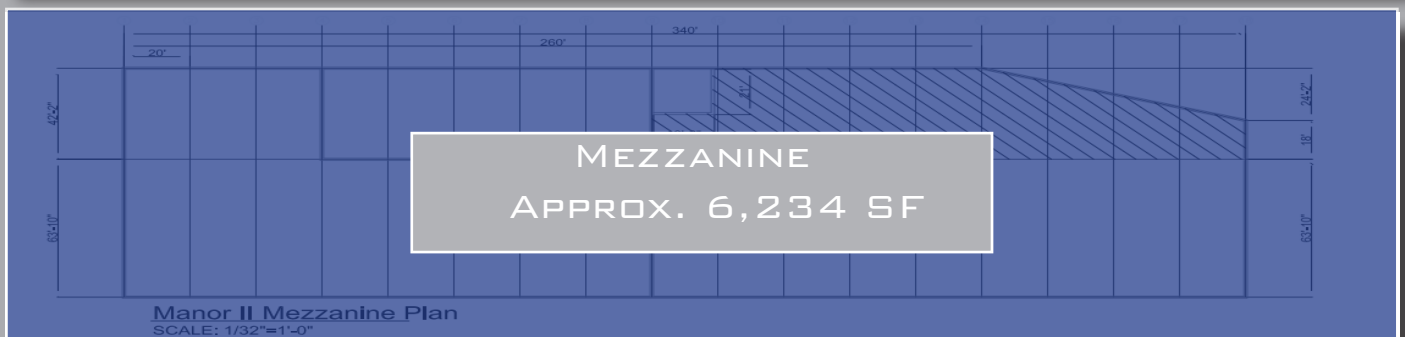

THE LOCATION

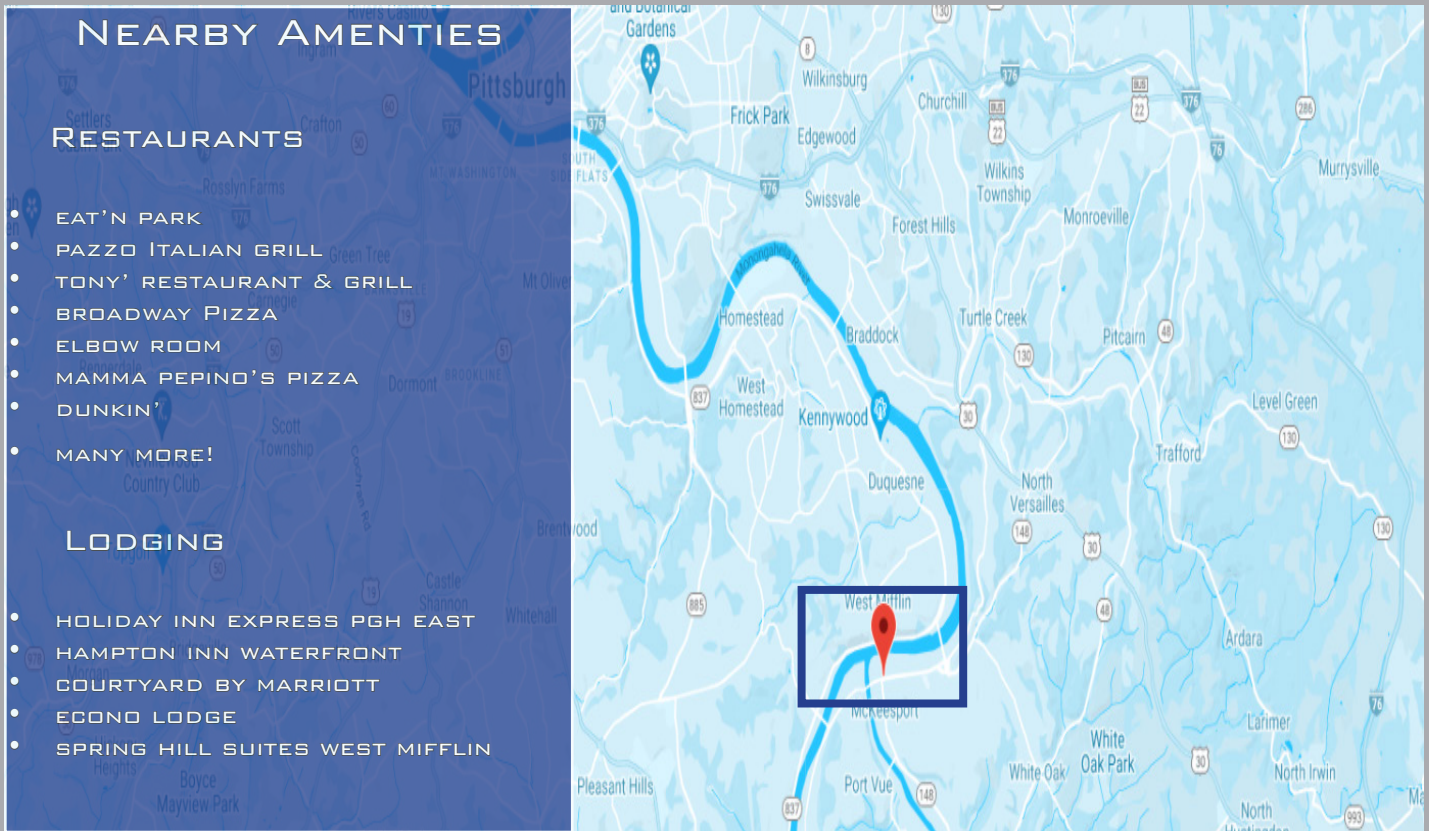

LANDLORD SPOTLIGHT

RIDC IS A NONPROFIT ORGANIZATION FOUNDED BY AND FOR THE PITTSBURGH REGION. WE TRACE OUR HISTORY BACK MORE THAN 60 YEARS, TO A TIME WHEN LEADERS IN THE REGION ENVISIONED A ENTITY DEDICATED TO DEVELOPING PROPERTIES THAT WOULD SUPPORT OUR INDUSTRIAL BASE, CREATE JOBS, AND GROW OUR ECONOMY. RIDC WENT ON TO PIONEER THE REGION'S FIRST INDUSTRIAL PARKS, AND WHEN THE STEEL INDUSTRY DECLINED, WE CONTINUED TO SUPPORT THE REGION BY TAKING ON THOSE ABANDONED INDUSTRIAL SITES, ATTRACTING NEW TECHNOLOGY-BASED COMPANIES AND RETURNING THOSE PROPERTIES BACK ON TO THE TAX ROLLS.

TODAY, WE ARE STILL DEDICATED TO CATALYZING ECONOMIC GROWTH IN SOUTHWESTERN PENNSYLVANIA THROUGH REAL ESTATE DEVELOPMENT THAT CAPTURES GROWTH OPPORTUNITIES ACROSS DIVERSE INDUSTRY SECTORS AND FOSTERS INCLUSIVE HIGH-QUALITY JOB CREATION. FROM THE PITTSBURGH TECHNOLOGY CENTER TO THE SUSTAINABLE MILL 19, RIDC HAS BEEN ON THE FOREFRONT OF PROVIDING SPACES FOR THE GROWTH OF TECHNOLOGY AND INNOVATION WITHIN THE SOUTHWESTERN PA REGION. WE VIEW RIDC'S SUCCESS AS PART OF A LARGER VISION FOR OUR REGION; OUR DECISIONS ARE MOTIVATED BY THE ECONOMIC DEVELOPMENT POTENTIAL OF OUR PROJECTS AND THE ABILITY OF OUR FACILITIES AND OUR TENANTS TO IMPACT THE OVERALL COMMUNITY.

RIDC

REGIONAL INDUSTRIAL DEVELOPMENT CORPORATION



MANOR II

INDUSTRIAL CENTER OF MCKEESPORT

LEASING CONTACT

MICHAEL HEINRICHER
DIRECTOR OF ASSET MANAGEMENT
MHEINRICHER@RIDC.ORG
412-315-6456

