

BEAVER INDUSTRIAL MANOR HOPEWELL BUSINESS PARK

ALIQUIPPA, PA



WWW.RIDC.ORG

RIDC

Regional Industrial Development Corporation

113 CORPORATION DR

- 5,025 SQUARE FEET
- FLEX SUITE
- 50% OFFICE, 50% WAREHOUSE
- 18' CONDITIONED WAREHOUSE
- 1 DOCK DOOR
- 2:1000 PARKING
- QUICK ACCESS TO I-376
- SIGNAGE OPPORTUNITY



113 CORPORATION DR - FLOOR PLAN



BEAVER INDUSTRIAL MANOR
113 CORPORATION DRIVE
ALIQUIPPA, PA 15001
5,025 RSF

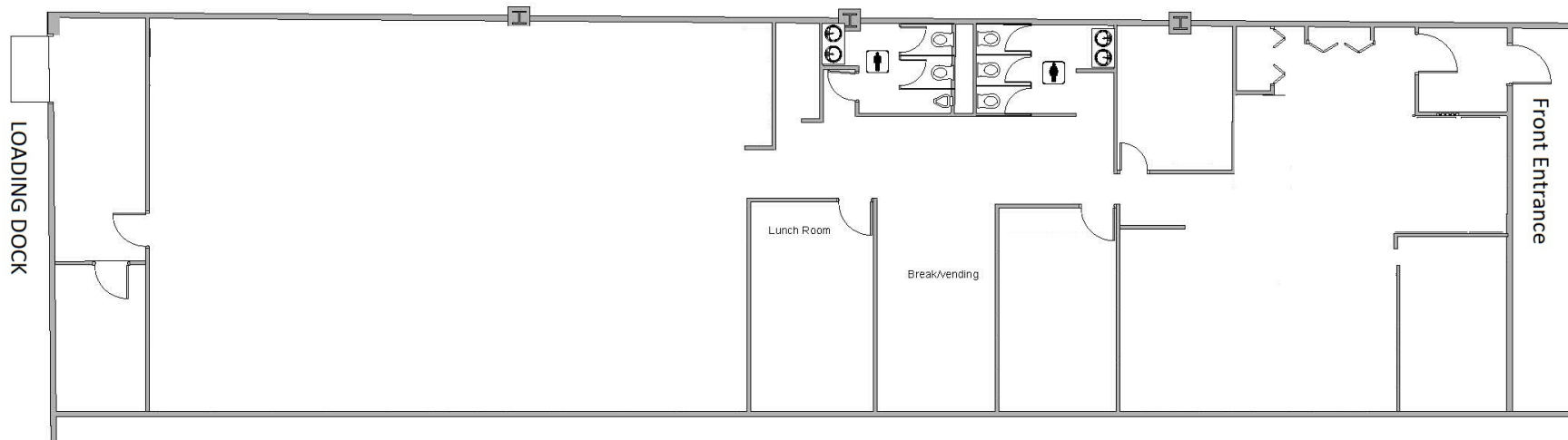

ABOUT THE PARK

In the late 1980s, RIDC designed and constructed a multi-occupancy building in Beaver County Corporation for Economic Development's Hopewell Industrial Park in order to help spur private investment in the site. The development was part of a larger strategy to assist development in the outlying counties. RIDC still owns the building, and it is home to 3 companies and over 85 jobs. Office Depot recently signed a 5-year lease for 15,000 square feet of flex warehouse space in Beaver Industrial Manor. One vacancy remains for a flex/office user who may wish to locate within minutes of the new Shell cracker plant.

NEARBY AMENITIES

Restaurants

Harold's Inn
Patrick's Irish Pub
Yianni's
The Hangar
Don Jose Mexican Grill
Trenney's Grille
Vocelli Pizza
Primanti Brothers
Two Chefs Catering
And Many More!

Lodging

Hyatt Regency (PIT)
Double Tree by Hilton (PIT)
Hilton Garden Inn (PIT)
Hampton Inn Airport
Sheraton Pgh Airport

Entertainment

Pittsburgh Int'l Airport
Robert Morris University
Raccoon Creek State Park
Ambridge Reservoir

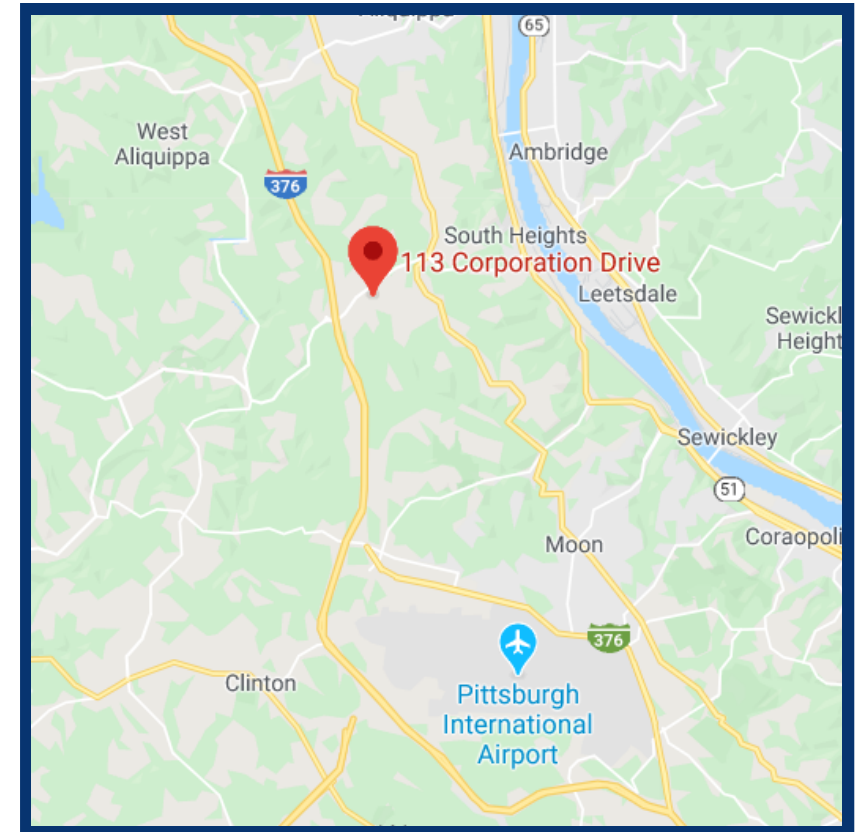

CONTACT US

EMILY SIPES, LEASING MANAGER
ESIPES@RIDC.ORG
412-697-3203



RIDC

Regional Industrial Development Corporation

611 William Penn Place, Suite 600 ▪ Pittsburgh, PA 15219
(412) 471-3939 ▪ www.ridc.org

Regional Industrial Development Corporation (RIDC) makes no guarantees, warranties or representations as to the completeness or accuracy of the information included. Information was obtained by reliable sources and is believed to be accurate. Rental terms and dimensions are approximate and specifications are subject to change without notice. Presentation of this property is subject to errors, omissions, change of price or conditions prior to sale or lease, or withdrawal without notice.